

INSTALLATION:

The ControlAir Type-400 is designed for air service only and maximum supply pressures are described on the individual labels. Operating temperatures are 0° to 160° F.

Install the regulator as close as possible to the instrument or tool it is to service. The words "IN" and "OUT" are cast into the body to indicate the direction of flow. If a lubricator is to be used in the system, install it down stream.

OPERATION:

Before turning on the supply air, back out the adjusting screw until there is no compression on the regulating spring. Turn on the air supply and turn the adjusting screw clockwise until the desired output pressure is reached.

MAINTENANCE:

A repair kit is available for the Type-400. To install replacement parts:

- 1) Order kit as described in exploded view below
- 2) Shut off air supply. Back out adjusting screw
- 3) Remove 4 screws and bottom plug. Then remove all parts
- 4) Replace appropriate parts with items from kit.
- 5) Clean all parts and reassemble

Contact factory with any questions.

LIMITED WARRANTY & DISCLAIMER:

ControlAir, Inc. products are warranted to be free from defects in materials and workmanship for a period of one year from the date of manufacture, provided said products are used according to ControlAir, Inc. recommended usages. ControlAir, Inc.'s liability is limited to repair of, refund of purchase price paid for, or replacement in kind of, at ControlAir, Inc.'s sole option, any products proved defective. ControlAir, Inc. reserves the right to discontinue manufacture of any products or change products materials, design or specifications without notice.

WARNING:

These products are intended for use in industrial compressed-air systems only. Do not use these products where pressures and temperatures can exceed those listed under Specifications.

Before using these products with fluids other than air, for nonindustrial applications, life-support systems, or other applications not within published specifications, consult ControlAir, Inc.

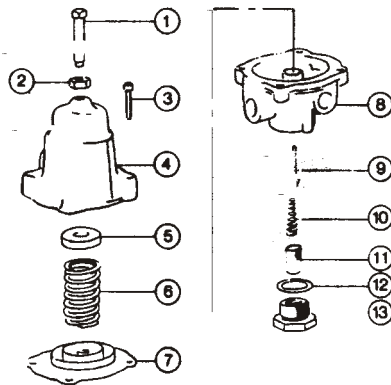

Type 400 Pressure Regulator

1. Sq. Hd. Adjusting Screw
2. Nut, Lock
3. Phillips Screw
4. Bonnet
5. Guide, Spring
6. Spring, Range
7. *Diaphragm Assembly
8. Body
9. *Pintle, Valve
10. *Spring, Pintle
11. *Screen
12. *Gasket, Plug
13. Plug, Bottom

All items marked with an asterisk (*) will be included in the repair kit. Other parts may be ordered separately by specifying the item number, part name, and the part number of the regulator for which